

**ROTAX**  
KARTING



# **BARCODE SCAN APPS**



**QUICK SETUP-GUIDE**  
for EVA-EMS and EVA-SCC

<b>TABLE OF CONTENT</b>		<b>Page</b>
<b>1.</b>	<b>PREFACE</b>	<b>3</b>
<b>2.</b>	<b>COMMERCIAL SCAN APP</b>	<b>4</b>
2.1.	Getting started	4
2.2.	Setting up the service	5
2.3.	Capturing and evaluating a barcode	6
<b>3.</b>	<b>SEMI-INDUSTRIAL SCAN APP</b>	<b>7</b>
3.1.	Getting started	7
3.2.	Setting up the service	8
3.3.	Capturing and evaluating a barcode	10
<b>4.</b>	<b>INDUSTRIAL SCAN APP</b>	<b>11</b>
4.1.	Creating an account	11
4.2.	Setting up the service	12
4.3.	Getting started	13
4.4.	Capturing and evaluating a barcode	14

## 1. PREFACE

Retrieving data manually is always a time-consuming procedure. With the help of barcode labels and suitable reading devices, this is a quick job even for larger volumes. There are a lot of barcode readers on the market, capable to decode nearly everything under nearly all conditions. But these devices are expensive and many applications do not need such a high performance.

The solution are software applications (apps) for mobile devices like smartphones or tablets. But also here a lot of barcode scan apps are on the market – some capable, some just to play around. Here are 3 recommended apps and the instructions how to get them working with EVA:

Smartphone and/or Tablet Scan App			
<b>Product name</b>	codeREADr	Manatee Works	Barcode
<b>Supplier</b>	Skycore	Cognex	Cocologics
<b>Current version</b>	2.11.13 (22.02.2017)	3.4.3 (13.04.2017)	3.0 (03.05.2017)
<b>Language</b>	English	English	Multilingual
<b>Price</b>	USD 8,99 (per month and device)	free of charge	USD 0,99 (only once)
<b>Operating systems</b>	iOS, Android	iOS, Android, Windows mobile	iOS
<b>Scan engine</b>	Industrial standard	Semi-industrial standard	Commercial standard
<b>User definable apps</b>	Unlimited	Unlimited	1
<b>Ease of setup</b>	Complex	Simple	Simple
<b>Ease of use</b>	Simple	Simple	Simple
<b>EVA supported</b>	EMS, SCC	EMS, SCC	EMS, SCC
<b>EVA recommended functions</b>			
<b>- EMS Inspection</b>	Excellent	Suitable	Suitable (with limitations)
<b>- SCC Tyrecheck</b>	Excellent	Suitable	Suitable (with limitations)
<b>- SCC Sealcheck</b>	Excellent	Suitable	Not recommended

## 2. COMMERCIAL SCAN APP

Name: Barcode  
Supplier: Cocologics

Availability: iOS



<https://itunes.apple.com/de/app/barcode/id522354642>

### 2.1. Getting started



Download the Barcode App and start the application.  
The app will show up with the following screen:

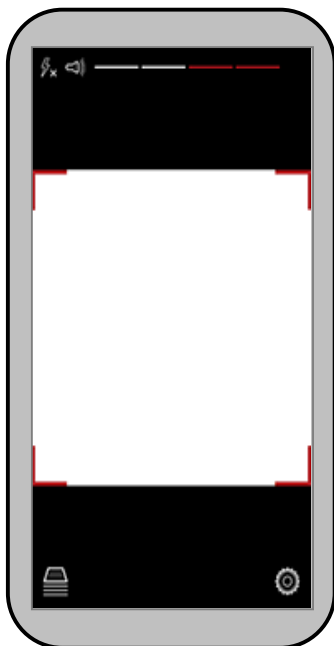

Turn camera light on/off and dim



Call scan history



Call system properties (settings)



Capture barcode

## 2.2. Setting up the service

Tab  in the bottom right to start the properties setup.  
The system will come up with the following menu:

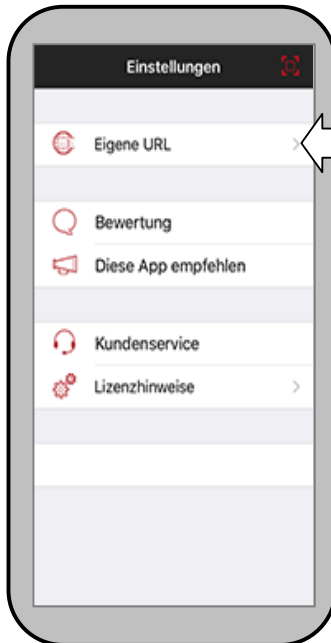

Tab here to enter your settings.



Enter your service as follows:

*http://ems.evanet.at/inspection?code=*  
or *http://scc.evanet.at/tyrecheck?code=*  
or *http://scc.evanet.at/sealcheck?code=*

*&username=<username>&password=<password>*

Any label name you want to see in the scan menu  
(e.g. Tyrecheck)

where <username> is your username and <password> is your password your are using for your EMS- or SCC-Login. Example:

*&username=peter.kessler@brp.com&password=test123*

Tab  **Einstellungen** in the upper left to exit from the setup.

### 2.3. Capturing and evaluating a barcode

Tab  to capture a barcode. As soon as the scanner has recognized the barcode the system will come up with the following screen:

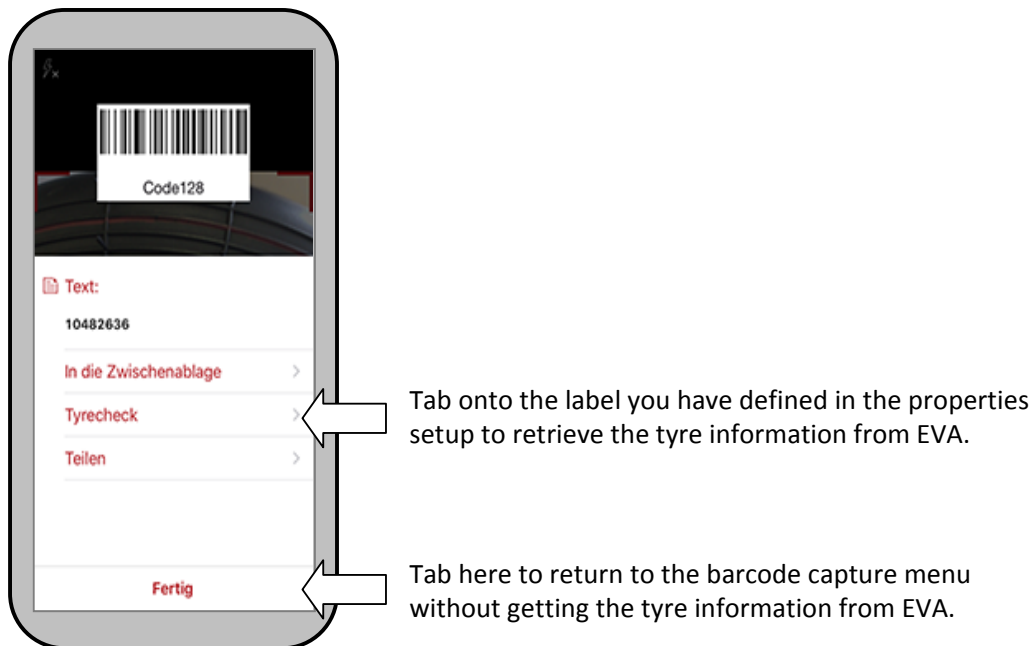

Depending on your application, the system will then show up with the result.

Tab  Zurück zu Barcode in the upper left to return to the barcode app.

### 3. SEMI-INDUSTRIAL SCAN APP

Name: Manatee Works

Supplier: Cognex

Availability: iOS, Android, Windows mobile



<https://itunes.apple.com/us/app/manatee-works-barcode-scanner/id504201315?mt=8>



<https://play.google.com/store/apps/details?id=com.manateeworks.barcodescanners>



<https://www.microsoft.com/de-at/store/p/barcode-scanners/9nblggh0ckqv>

#### 3.1. Getting started



Download the Barcode App and start the application.  
The app will show up with the following screen:



Call system settings



Call sting ray mode



About this app



Zoom



Turn camera light on/off



Call scan history

### 3.2. Setting up the Service

Tab  on the top left to start the setup procedure and follow the sequence 1-6 as follows:

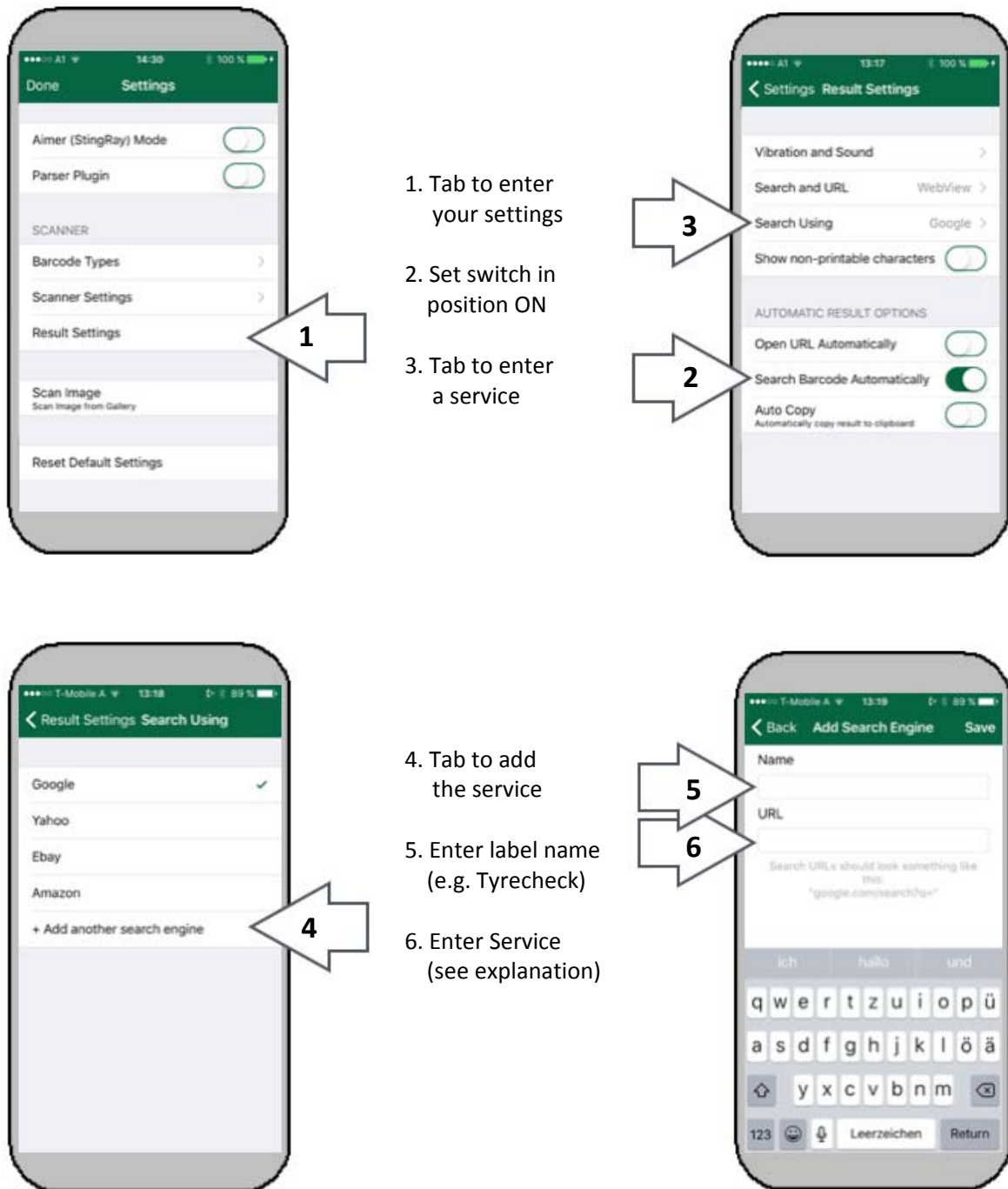



## How to enter a Service

A Service consists of the function you want to execute and your access data. It has the following format:

*http://ems.evanet.at/inspection?username=<username>&password=<password>&code=*  
 or *http://scc.evanet.at/tyrecheck?username=<username>&password=<password>&code=*  
 or *http://scc.evanet.at/sealcheck?username=<username>&password=<password>&code=*

where <username> is your username and <password> is your password you are using for your EMS- or SCC-Login. Example:

*http://scc.evanet.at/tyrecheck?username=peter.kessler@brp.com&password=test123&code=*

Tab **SAVE** in the upper right to store your entries.

Repeat this procedure as many times as you want to create services.

Before exiting the menu, activate the desired service by tabbing onto it:



**Note:** If you did something wrong with the specification of your service, you must delete it (by sliding from right to left) and repeat the procedure from scratch.

### 3.3. Capturing and evaluating a barcode



If not already done at setup time, tab  and goto the Result Settings to check if your service is activated. Otherwise you can immediately start to scan a barcode.

To capture a barcode just hover your device camera over it (no buttons are required).

When needed tab here for light or zoom

As soon as the scanner has recognized the barcode the system will come up with the result depending on your application. Tab **DONE** in the upper left to scan another barcode.

## 4. INDUSTRIAL SCAN APP

Name: codeREADr

Supplier: Skycore

Availability: iOS, Android



<https://itunes.apple.com/ml/app/codereadr-enterprise-barcode/id389044458>



<https://play.google.com/store/apps/details?id=com.skycore.android.codereadr>

### 4.1. Creating an account

This app is a chargeable service and therefore needs an account (registration). Charges are done monthly giving you the possibility to downgrade to the free version and revert back to the paid plan at any time. The change will take effect at the end of your monthly billing cycle.

Since BRP-Rotax has been granted special conditions (advanced scan engine and reduced price) the procedure to create an account and to obtain all benefits is slightly different from the standard:

Step 1:

Send an email to [support@codereadr.com](mailto:support@codereadr.com) with the subject 'BRP Account Setup'. In the body of the email you must specify the email address you want to use for the **codeREADr** account. That email address is used to sign into the **codeREADr** web site and to receive periodic notices. You may change the email address (and also add a second email address to which invoices will be sent monthly) at any time on the account settings page lateron.

Step 2:

The team of **codeREADr** will set up the account for you with a temporary password. You can change that password on the account settings page lateron. They will also set up the account with BRP's special price including the advanced scan engine SD PRO and set the start of their monthly billing period to the first day of each month. You will receive an email when done which includes a link to the account billing page where you must enter your credit card information. Send a reply to the email after the card information has been entered.

## 4.2. Setting up the service

Once you have got your account information from **codeREADr**, you can setup the service.

✉

🔒

Goto [www.codereadr.com](http://www.codereadr.com)  
 Tab **Sign In** on the top right  
 Enter your account name and password  
 Tab **Sign In** to confirm your entries

Choose **Services** (if not yet selected) from the top menu and tab **Create a Service**

**Redirect Scans to a Third Party Server**  
For advanced users - requires IT integration.

**Where would you like to send your scans?**

This URL will receive various scan parameters, such as barcode ID, device ID, service ID, etc.

**Skip our server and go directly to yours.**

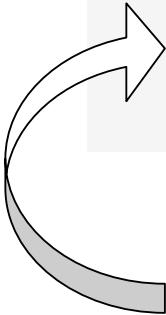

Select the radio button 'Redirect Scans to a Third Party Server'.  
 Check 'Skip our Server and go directly to yours'.

Then enter the following into the free field:  
<http://ems.evanet.at/inspection?username=<username>&password=<password>&code=>  
 or <http://scc.evanet.at/tyrecheck?username=<username>&password=<password>&code=>  
 or <http://scc.evanet.at/sealcheck?username=<username>&password=<password>&code=>

where <username> is your username and <password> is your password  
 you are using for your EMS- or SCC-Login. Example:

<http://scc.evanet.at/tyrecheck?username=peter.kessler@brp.com&password=test123>

Tab **Create Service** to confirm your entries.

**Name**



Enter any label name (Example: Tyrecheck) you want to see in the scan menu and tab **Save and Continue**

You can skip the following steps by tabbing 3 times **Save and Continue** then tab **Done** to finish.

Repeat this procedure as many times as you want to create services.

### 4.3. Getting started



Download the codeREADr App start the application.  
The app will show up with the following screen:

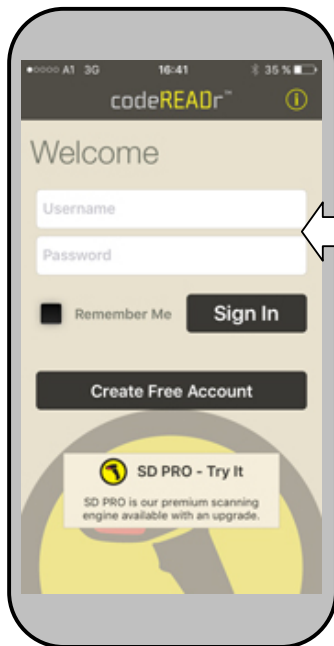

Enter your codeREADr username and password.  
Tab  to confirm your entries.

Tab here to return to the login menu 

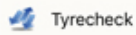
Tab onto the label you have defined in the service setup to start the service 

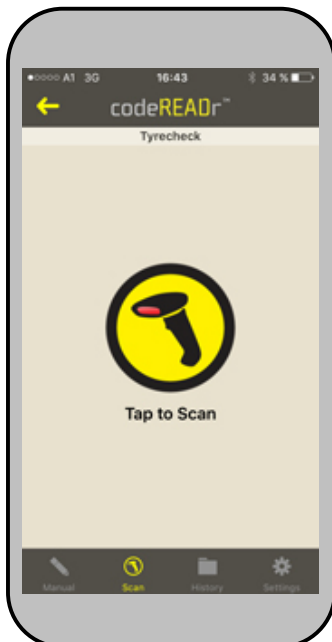
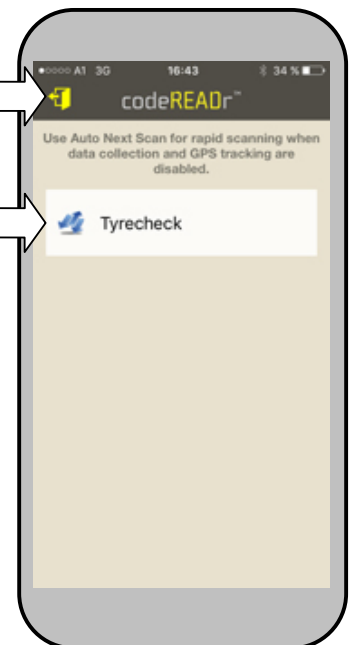

Call manual input



Call barcode scan



Call scan history



Call system settings

Tab the **SCREEN** to start scanning or  on the top left to return to the service selection menu.

#### 4.4. Capturing and evaluating a barcode

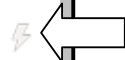
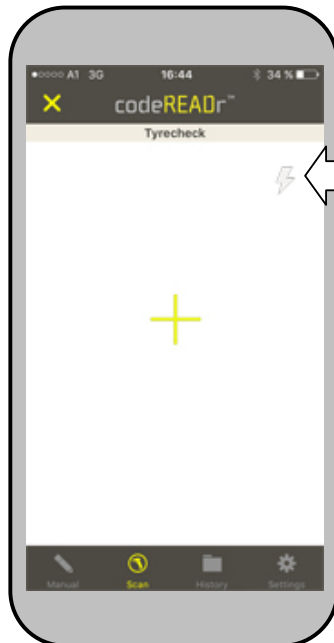

When needed tab here to switch the light half on, full on or off

To capture a barcode just hover your device camera over it  
(no buttons are required)

As soon as the scanner has recognized the barcode, the system will show up with the result depending on your application. Tab **NEXT** at the bottom to scan another barcode or **X** in the upper left to return to the main menu.



**SKYCORE**  
MOBILE SERVICES

**DATALOGIC**<sup>TM</sup>

